

SW-E10 Series:

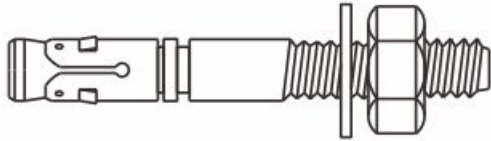

Material: S.S. 304 / S.S. 316

 (Cracked Concrete Tested
ETAG-001-Annex-A)

Tested By:

Tested as per BS 5080

Installation Parameters

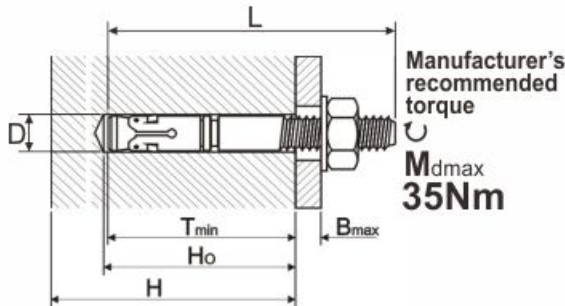

Installation Parameters Table

Item	Model	SW-E10x75	SW-E10x100
H (mm) Min, Concrete thickness.		100	100
D (mm) Drill hole diameter		10	10
H _o (mm) Manufacturer's recommended drill hole depth		60	60
T _{min} (mm) Manufacturer's recommended embedment depth		50	50
B _{max} (mm) Max. Thickness of installation material		10	23
L (mm) Anchor total length		75	100
M_{dmax}	Manufacturer's recommended torque	35Nm	35Nm

Range of application:

Item to be application	
<ul style="list-style-type: none"> ○ Steel channel ○ Steel frame ○ Metalwork ○ Wooden structure ○ Mechanical equipment ○ Highway fences & dividers ○ Electronic equipment 	<ul style="list-style-type: none"> ○ Aluminum windows and louvers ○ Cladding works ○ Stone facades ○ Curtain wall ○ Handrail ○ Suspending objects
Characteristics	
<ul style="list-style-type: none"> ○ Corrosion resistant ○ Quick acting ○ Small edge distance & separation of anchor 	<ul style="list-style-type: none"> ○ Stabilize on moving objects ○ Releasable ○ Mechanical fixing
Base Material	
<ul style="list-style-type: none"> ○ Non-cracked concrete ○ Cracked concrete 	

Installation Procedure

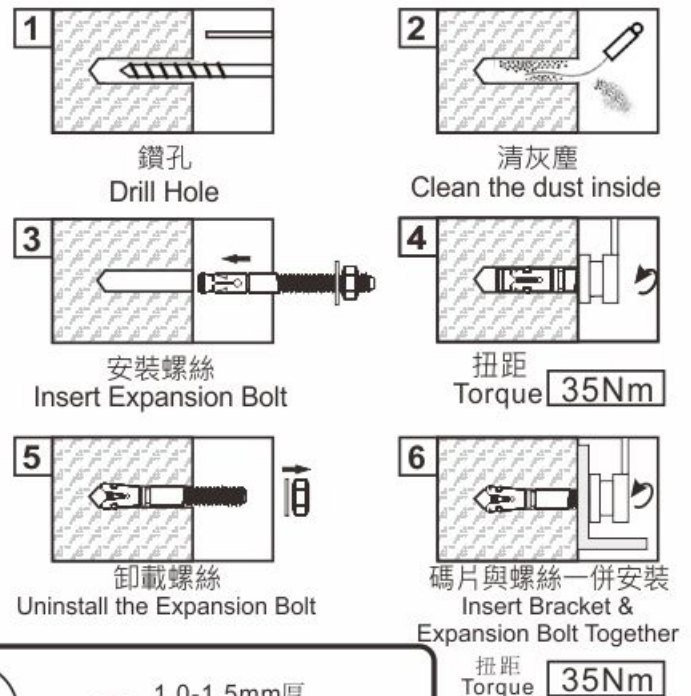



2mm厚



20mm

1.0-1.5mm厚



15-16mm

SUNWAY膨脹螺絲外用之不銹鋼介子更強抓著力

一般市面膨脹螺絲外用之不銹鋼介子

SUNWAY Stainless Steel Washer of Expansion Bolt can secure the bolt better than the general Stainless Steel Washer of Expansion Bolt .

如需更多資料或有任何疑問，請與我們聯絡。

For more information, please contact us.

Tel : (852) 2552 5210 , E-mail : sunway@sunwayltd.com.hk

Fax: (852) 2814 0776 , Website : http://www.sunwaymetal.com/